



B B C The Switchover Help Scheme
is run by the BBC.

GDR1011RT 06/11



Tuning your Goodmans set-top box



There are two stages to the digital switchover. Your letter will tell you when these two stages take place.

You will need to follow these step-by-step instructions to continue watching all TV channels for Stage 1 of the digital switchover.

Stage 1 of the digital switchover

Stage 1 is where BBC Two becomes digital. To continue to watch BBC Two after the first switchover, simply follow these step-by-step instructions.

Step 1. Point the digital remote towards your new digital box and press the  button on your digital remote. Your TV will show the **'Welcome'** screen.

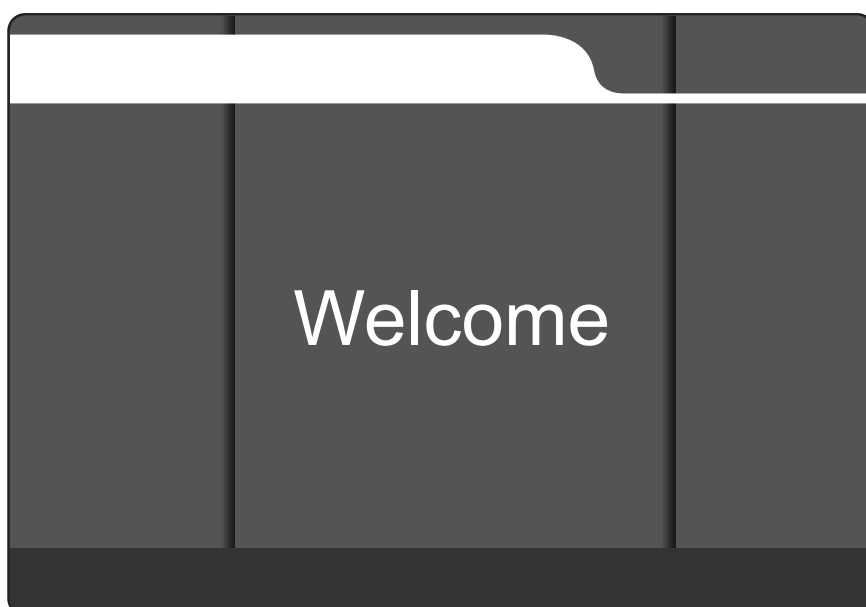

Need help? Just call us free on
0800 40 85 935

Please turn the page for the next steps.



Make sure you have followed step 1 on the previous page.

Step 2. After a few seconds the screen will show the TV format screen. Using the ◀ and ▶ arrow buttons on your digital remote select the correct format for your TV either widescreen (16:9) or standard (4:3). Press **'OK'** to confirm selection.

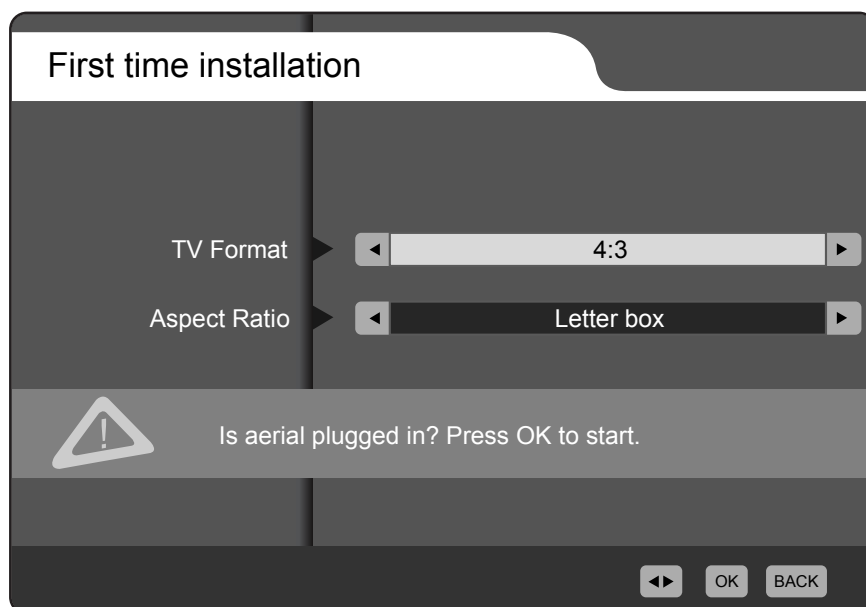

Step 3. Your digital equipment will now start searching for channels. When all available TV and radio channels have been found the TV screen will show **'Installation Complete'** screen.



Step 4. Your digital box may be able to get a signal from another TV region. If other regions are available you will see the TV region selection screen. The TV region with the best signal and most channels will be shown on the top of the list of available TV regions. Use the ▲ and ▼ arrows on your digital remote to choose the TV region you want. Press **'OK'** button to confirm selection.

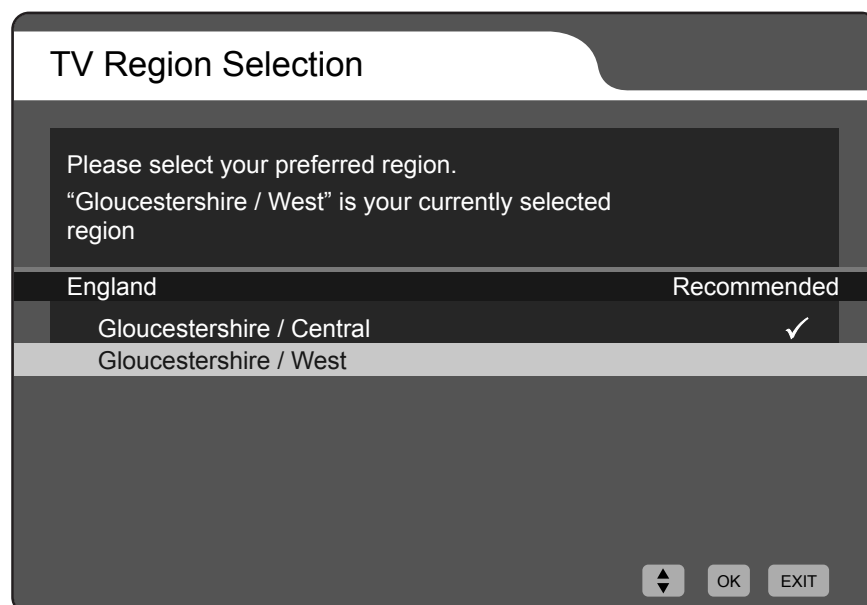

Stage 2 of the digital switchover

Stage 2 is when all channels switch to digital. In order to continue to watch all channels you will have to retune your digital box. You will see a message on your TV screen that will say **"Please press 'OK' to re-tune"**. Press **'OK'** on your digital TV remote and your digital box will retune itself.

Need help? Just call us free on
0800 40 85 935